

LINN

SONDEK LP12

TRANSCRIPTION TURNTABLE

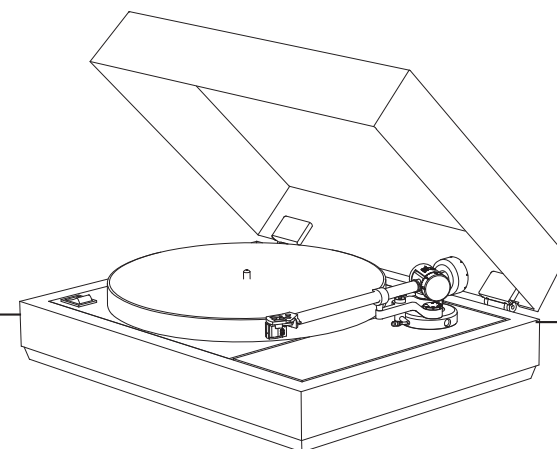

OWNER'S MANUAL

SONDEK LP12

OWNER'S MANUAL

COPYRIGHT AND ACKNOWLEDGEMENTS

Copyright © 2009 Linn Products Ltd. First edition March 2008, updated April 2009 .

Linn Products Limited, Glasgow Road, Waterfoot, Eaglesham, Glasgow, G76 0EQ, Scotland, United Kingdom

All rights reserved. No part of this publication may be reproduced, stored in a retrieval system, or transmitted, in any form or by any means, electronic, mechanical, photocopying, recording, or otherwise, without the prior written permission of the publisher.

The content of this manual is furnished for information use only, is subject to change without notice, and should not be construed as a commitment by Linn Products Limited. Linn Products Limited assumes no responsibility or liability for any errors or inaccuracies that may appear in this manual.

Trade marks used in this publication: **Linn**, the **Linn logo**, **Sondek** and **Majik** are registered trade marks of Linn Products Limited. **LP12** is a trade mark of Linn Products Limited.

Pro-Ject is a registered trade mark of H. Lichtenegger.

Linn Products Limited disclaims any proprietary interest in trade marks and trade names other than its own.

Pack 1396/E

SONDEK LP12

OWNER'S MANUAL

CONTENTS

INTRODUCTION	1
Upgrading your LP12	1
INSTALLATION	2
OPERATION	3
TURNTABLE MAINTENANCE	4
GENERAL SYSTEM MAINTENANCE	5
TRANSPORTATION	6
TECHNICAL SPECIFICATIONS	7
GUARANTEE AND SERVICE	8

SONDEK LP12

OWNER'S MANUAL

INTRODUCTION

In 1972, Ivor Tiefenbrun, the founder of Linn Products, first demonstrated the Sondek LP12 turntable; and, if you excuse the pun, it started a revolution.

Prior to the Sondek LP12, conventional thinking was that the loudspeakers were the most important element of a hi-fi system. Ivor and the Sondek LP12 turned this completely around and proved that it was the other end of the hi-fi chain, the turntable, that was most significant. After all, loudspeakers can only reproduce the signal that is fed to them. So if the power amplifier and pre-amplifier degrade the signal and lose some of the audio information, and the turntable does so too, then not even the best loudspeakers in the world can bring that music back. On the other hand, if the turntable extracts the maximum information from a record that it can, if a little of that audio signal is lost further along the path then even average loudspeakers can still produce excellent results.

Extracting the maximum information from a record is what the Sondek LP12 has been doing for more than thirty-five years, making it the longest-lived hi-fi product still in production anywhere in the world, and the benchmark by which all other turntables are judged.

Enjoy...

Upgrading your LP12

A series of upgrade components are available which allow you to transform the performance of your LP12. Your Linn retailer will be able to advise you on the next upgrade that is right for you.

Generally speaking, Linn recommend that upgrades are carried out according to our 'source first' hierarchy - that the components most important to the original source are upgraded first as you progress down the signal path.

The suggested order for upgrading is roughly as follows: LP12 Transport (Sub-chassis, Baseboard etc.), Motor and Power Supply, Tonearm and Arm-cable, Cartridge, Phono Stage, Pre-amplifier, Power-amplifier, Loudspeakers.

See www.linn.co.uk/music_systems_turntables for information on the latest Linn turntable components.

SONDEK LP12

OWNER'S MANUAL

INSTALLATION

In most cases, installation of the LP12 will be completed by your retailer, but the following points should be noted:

Majik LP12

Remove the baseboard and the power cable clip. Attach the power cable to the Majik LP12 Power Supply as shown below.

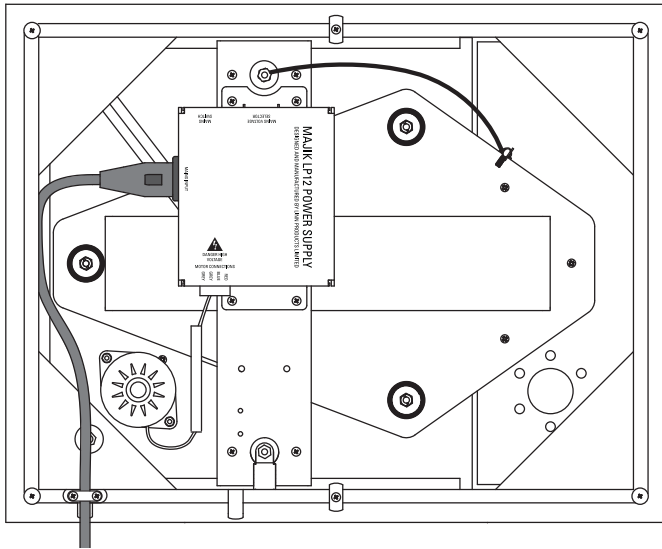

IMPORTANT:

Ensure you set the voltage switch on the Majik LP12 Power Supply to the correct setting for your country (either 115 V or 230 V).

Re-fit the power cable clip. Re-fit the baseboard once setup has been completed.

Tonearm

The loop on the nylon thread attached to the anti-skating weight should be attached to position two on the stub at the rear of the tonearm.

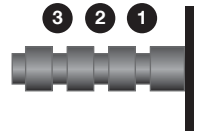

All LP12s

FLOOR MOUNTING Place the deck on a spiked hi-fi rack or a light, rigid table. It is very important that the LP12 sits on a level surface which does not rock.

WALL MOUNTING Wall mounting may be preferable if your floor is highly sprung (e.g. laminate flooring) or where there is risk of damage by children and pets. The shelf used should be light and rigid, and it should be fully supported by, but not firmly screwed or glued to, its brackets: this is to decouple the deck from the wall so as to avoid unwanted vibration.* If a lid is fitted, a clearance of 3" (7.5 cm) is required behind the plinth and at least 13" (33 cm) above.

It is quite normal for the deck suspension to settle slightly after installation. This will not affect performance.

* Further improvements can be achieved by mounting the shelf on spikes which sit on the brackets, or by upgrading the Majik LP12's baseboard to the Trampoline baseboard.

SONDEK LP12

OWNER'S MANUAL

OPERATION

The switch on the LP12 provides a trigger to the electronics to start or stop the motor. It does not break any mains connection. Power remains on the circuit board all the time, however, static power consumption is very low. After connection to the mains supply, the circuitry should be given a few seconds to settle before switching the motor on.

Majik LP12

In regions of low mains operating voltage and under certain conditions, it is possible that the motor may take longer than normal to begin turning the platter when the turntable is switched on. This can be overcome by gently rotating the platter in a clockwise direction. This does not in any way indicate a fault with the motor or Majik LP12 Power Supply.

The LP12 was designed to give optimum performance at 33 rpm, however, for owners of the Majik LP12, a 45 rpm adaptor is provided along with a second drive belt. We recommend that you only use the second drive belt with the adaptor, as the adaptor will cause the belt to stretch more, therefore it may not provide optimum performance if used when the adaptor is not in place.

To use the 45 rpm adaptor:

- Remove the felt mat and outer platter.
- Remove the drive belt.
- Place the adaptor, with the black o-ring at the top, over the motor pulley.
- Press down firmly and evenly on the adaptor until it clicks into place. (Notes: It is a very tight fit. When the adaptor is in the correct position it does not sit flush with the top of the pulley.)
- Fit the spare drive belt ensuring it passes through the belt guide.
- Replace the outer platter and mat.

Removal:

- To remove the adaptor, hold the Majik LP12 down with one hand and pull firmly upwards on the adaptor.

Sondek LP12 with Radikal

There are now two modes of operation that allow you to change speeds without stopping the turntable, one of which also allows you to mute the phono stage while you change record.

A switch at the back of the Radikal allows you to select between the following modes:

Normal Operation (Lingo)

- Simply press once to turn the LP12 on – speed will default to 33^{1/3} rpm.
- Press and hold for a couple of seconds to change speed to 45 rpm.
- Press and hold for a couple of seconds to return speed to 33^{1/3} rpm
- A short press from either speed will turn the LP12 off.

Enhanced (With Mute)

- Simply press once to turn the LP12 on – speed will default to 33^{1/3} rpm.
- A short press will apply a soft mute (-25dB) to the phono stage while you replace the stylus. The LED will flash when muted – simply press again to restore volume.
- Press and hold for a couple of seconds to change speed to 45 rpm. A short press will enable and disable mute as above.
- Press and hold for a couple of seconds to return speed to 33^{1/3} rpm, or longer to turn the LP12 off.

SONDEK LP12

OWNER'S MANUAL

TURNTABLE MAINTENANCE

The LP12 is designed for a long operational life. To preserve the appearance and maintain the performance of your deck, please note the following points:

- **PLINTH** The plinth is constructed from solid kiln-dried hardwood and should not be subjected to extremes of temperature or direct sunlight. Some finishes will darken slightly with age. A dry lint-free cloth is ideal for cleaning dust from the plinth.
- **PLATTER** The platter will darken with age since the alloy is slightly photo-sensitive. Resist the temptation to repolish the rim, as this removes the protective lacquer and results in a rapid degradation of the finish. Clean only with a dry lint-free cloth.
- **MAT** The felt mat can be cleaned with masking tape. If the mat becomes very dusty, you can beat it like a rug. If you have a problem with static and the mat clings to your records, you can use some double-sided tape to secure it to the platter.
- **STAINLESS STEEL TOP PLATE** Clean with a dry lint-free cloth.
- **ARMBOARD** Clean with a dry lint-free cloth. Ensure the stylus guard is in place before you start.
- **PULLEY** The motor pulley should be cleaned periodically to remove deposits of rubber shed by the belt. To do this, remove the outer platter and belt, and gently apply a lint-free cloth with a little furniture polish on it, against the rotating motor pulley until clean. Remove any residual polish from the pulley using a dry part of the cloth.
- **BELT** The belt should last for at least five years of regular use. The belt can be cleaned at the same time as the pulley is cleaned. The best method of cleaning the belt is by pulling it through a lint-free cloth with a little furniture polish on it. Remove any residual polish from the belt by pulling it through a dry part of the cloth. If the belt is clean it should not leave any black marks on the cloth.
- **OIL** The oil supplied for the bearing provides life-long protection. If oil is lost from the bearing housing, it should be replaced by Linn-supplied oil (available from your Linn retailer). The turntable should never be operated without oil.
- **DUST COVER** This can be cleaned using any of the commercially available acrylic or plastic cleaners. Remove any dust with a slightly damp cloth without any rubbing action and then use a soft duster.

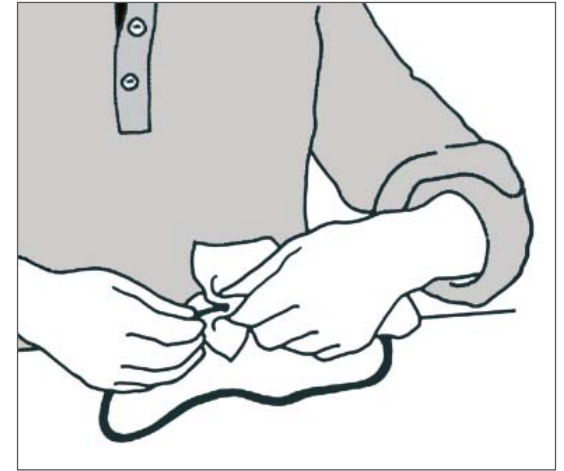

SONDEK LP12

OWNER'S MANUAL

GENERAL SYSTEM MAINTENANCE

1. It is important that the stylus is kept scrupulously clean. Your Linn retailer will be able to show you how to clean the stylus using Linn green stylus paper. Traditional soft stylus brushes are not effective.
2. Ensure the tonearm is set to the correct tracking weight and bias: every arm and cartridge combination has an optimum tracking weight (refer to the information supplied with the arm/cartridge). Temperature can alter this value, which will be lower in hot weather and higher in cold.
3. It is important that the electrical contacts in your hi-fi system are kept mechanically sound and clean. A poor contact, especially at the first connection in the system between the cartridge and arm, will degrade the signal substantially. Checks on all contacts should be performed periodically.
4. Most record cleaning devices do more harm than good. Linn suggest that you let the stylus remove any dirt which may be in the groove, then clean the stylus.

IMPORTANT - Sondek LP12 with Radikal:

With the accuracy of the new DC motor system there is no longer any benefit in leaving the motor running continuously (as many considered beneficial with the AC motor). We recommend that the turntable is switched off when not in use, as this will enhance the product lifetime and also consume less power.

SONDEK LP12

OWNER'S MANUAL

TRANSPORTATION

The LP12 is a precision engineered component, and as such, to avoid damage should be transported carefully in its original packaging. If transporting the turntable, please follow the instructions below.

- Remove the outer platter and place it in the bottom packing tray.
- Remove the inner platter and place it in the top tray.
- Fit the red bearing cap to the bearing housing to prevent oil spillage.
- Remove the counterweight from the tonearm.
- Remove the tonearm and cartridge. Under no circumstances should the turntable be transported with the arm fitted.

Majik LP12

- Do not remove the power cable: there is space for the plug in the top tray.

All LP12s

IMPORTANT:

When re-packing the turntable remove the two bottom cover screws, which are located between the turntable feet. If these screws are left in position during transportation they will damage the rim of the platter.

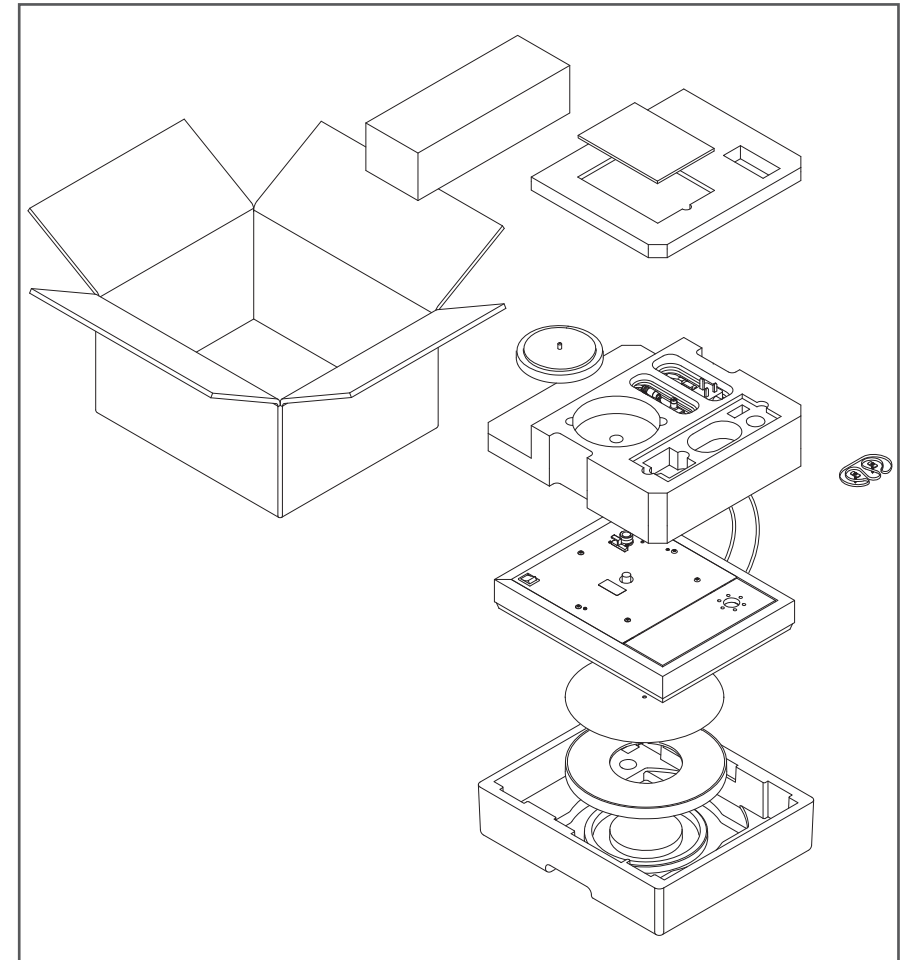
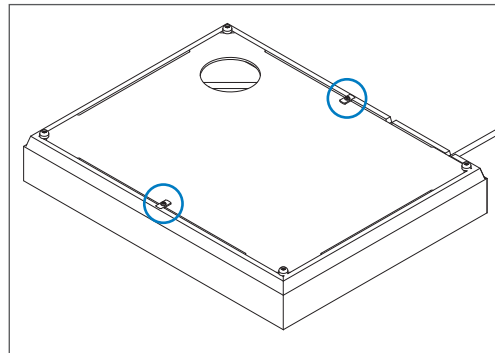

Illustration shows packaging for the Majik LP12

SONDEK LP12

OWNER'S MANUAL

TECHNICAL SPECIFICATIONS

All LP12s	
Platter	2 pieces, non-magnetic Mazak 8
Platter mat	Felt
Main bearing	1-point bearing, mirror finish, oil bath
Suspension	3-point sub-chassis, 3 adjustable precision springs
Motor*	High torque, 24 pole synchronous motor, fully screened and mechanically decoupled from main bearing
Drive	Neoprene flat belt, concentric precision pulley
Dimensions	445 (W) x 356 (D) x 140 (H) mm 17.5" (W) x 14" (D) x 5.5" (H)
Weight*	10 kg / 22 lb
Plinth finishes	Black Ash, American Cherry, Rosenut, Maple, Walnut

* Unless upgraded to Radikal, see across

Majik LP12	
Operating voltage	100-115 / 230 Vac
Operating frequency	50 – 60 Hz
Power consumption	11 VA max.

Radikal	
Motor	13 segment precious metal brushed DC motor
Mains Input Voltage (auto-sensing)	100 - 120 V 220 - 240 V
Mains Supply Frequency	50 - 60 Hz
Power Consumption	14 W (with Urika)

SONDEK LP12

OWNER'S MANUAL

GUARANTEE AND SERVICE

This product is guaranteed under the conditions which apply in the country of purchase and your statutory rights are not limited. In addition to any statutory rights you may have, Linn undertake to replace any parts which have failed due to faulty manufacture. To help us, please ask your Linn retailer about the Linn warranty scheme in operation in your country.

In parts of Europe, the United States of America and some other markets, extended warranty may be available to customers who register their purchase with Linn. You can register your warranty online at www.linn.co.uk.

WARNING

Unauthorised servicing or dismantling of the product invalidates the manufacturer's warranty. There are no user serviceable parts inside the product and all enquiries relating to product servicing should be referred to authorised retailers only.

Technical support and information

For technical support, product queries and information, please contact either your local retailer or Linn directly.

Full details of your local retailer/distributor can be found on the Linn web site: www.linn.co.uk

Important

Please keep a copy of the sales receipt to verify the purchase date of the product.

Please ensure that your equipment is insured by you during any transit or shipment for repair.

Linn Products Limited

Glasgow Road, Waterfoot, Eaglesham, Glasgow G76 0EQ, Scotland, UK

Phone: +44 (0)141 307 7777

Fax: +44 (0)141 644 4262

Helpline: 0500 888909

Email: helpline@linn.co.uk

www.linn.co.uk